

DETAIL 3513



**DURO-LAST, INC.**

525 Morley Drive  
Saginaw, MI 48601

Do not use this detail for Fully Adhered applications unless the membrane is back-sealed using Duro-Last caulk or strip mastic.

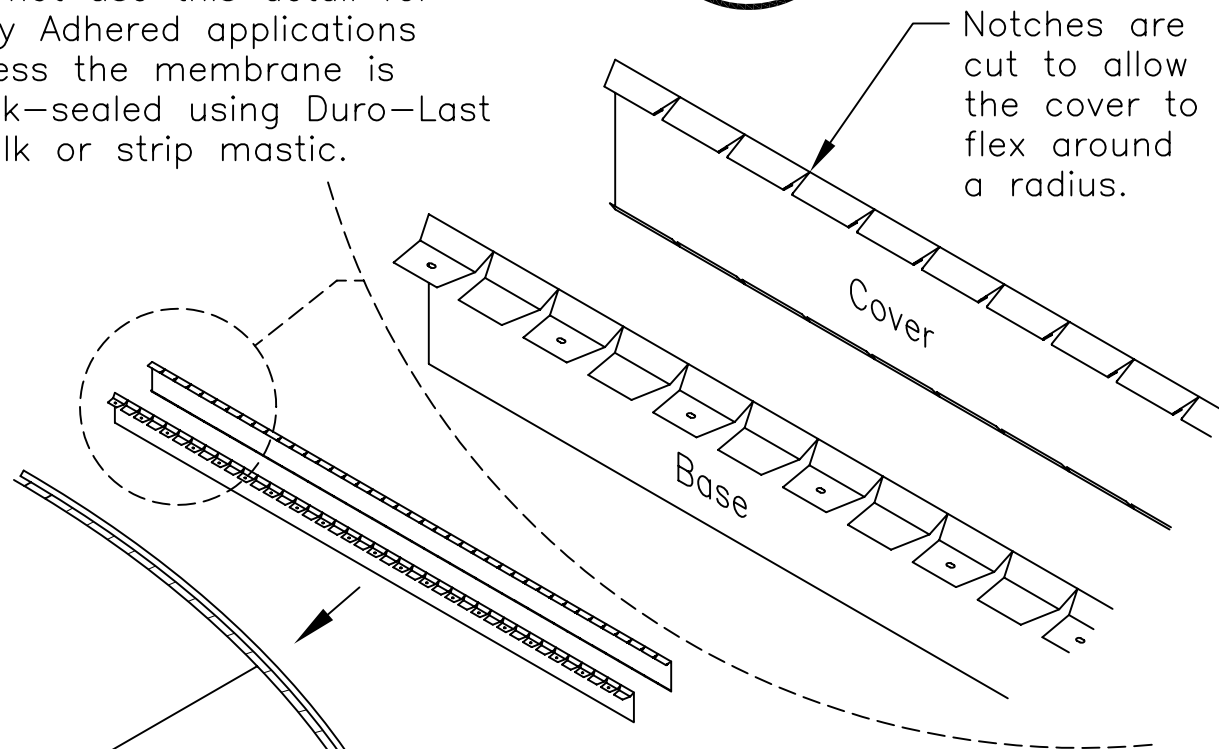

Notches are cut to allow the cover to flex around a radius.

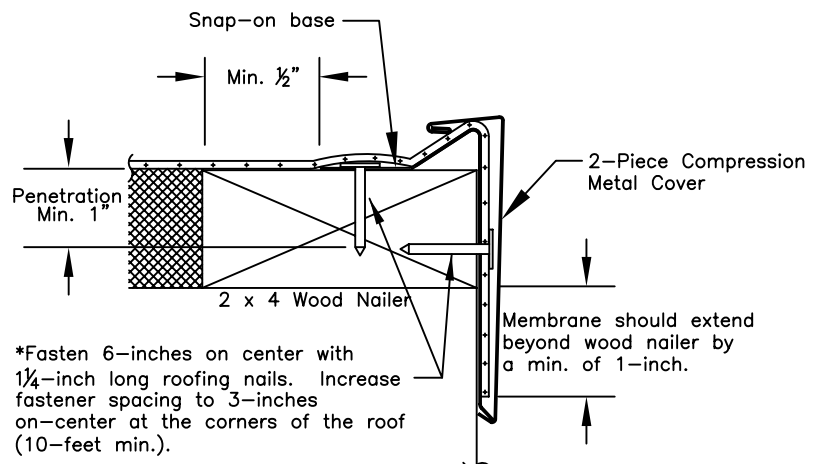
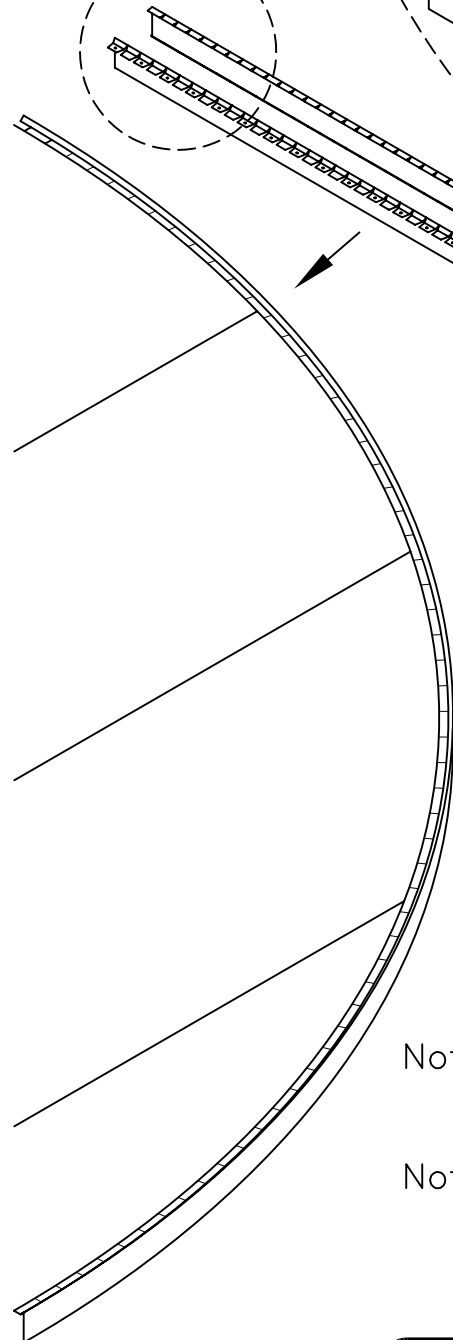

\*Fasten 6-inches on center with 1¼-inch long roofing nails. Increase fastener spacing to 3-inches on-center at the corners of the roof (10-feet min.).

\*\*This edging is available in various face sizes and standard Kynar® colors.

Membrane should extend beyond wood nailer by a min. of 1-inch.

Note 1: See Detail 3110 for installation instructions and requirements.

Note 2: This edge can be installed on both inside and outside radius edges.